

# Stage 4

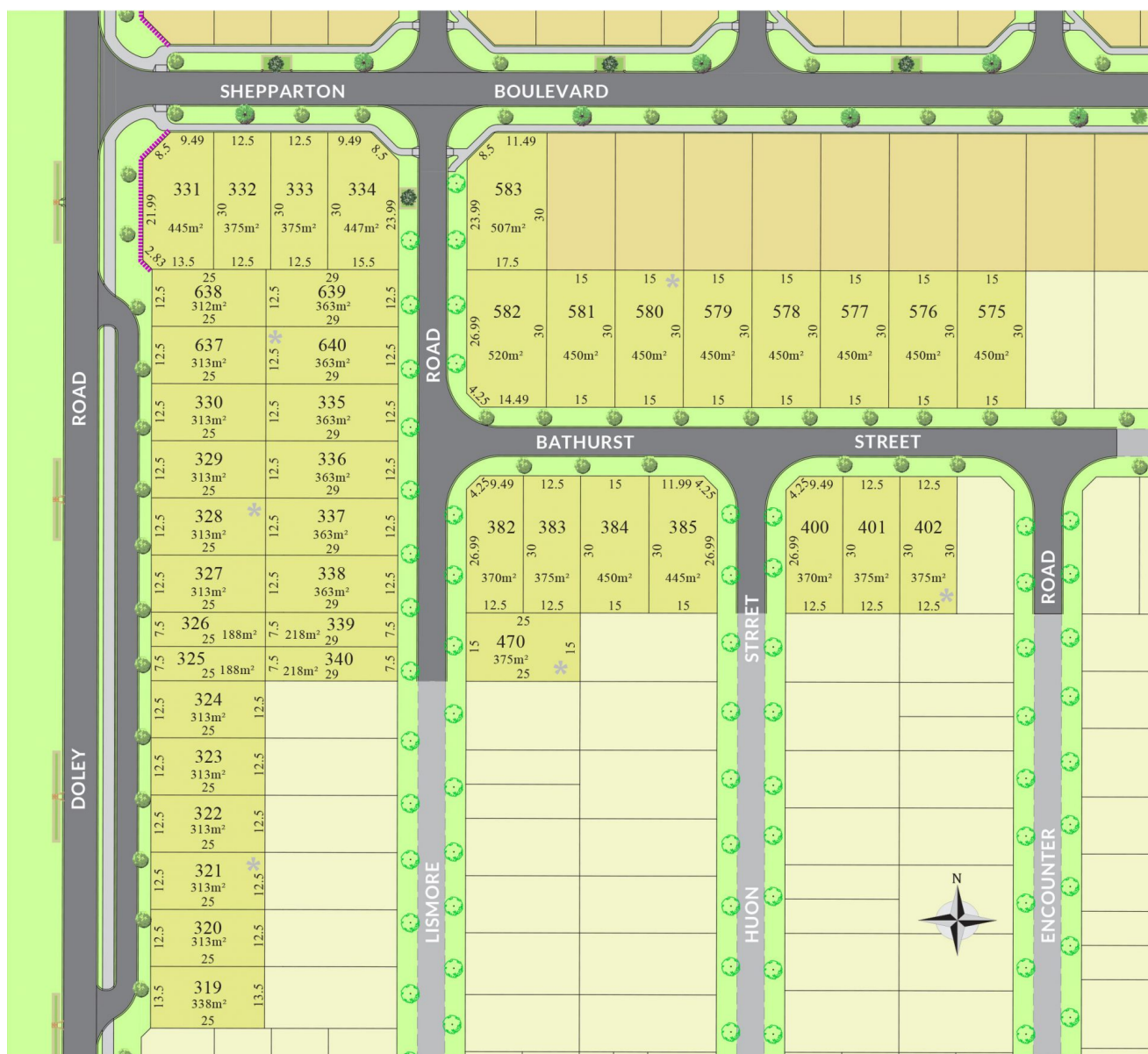

Lot/Address	Size (m <sup>2</sup> )	Frontage (m)	Depth (m)	Titles due	BAL	Status	Lot Price	Comments
Lot 334 Shepparton Boulevard	447		30	Aug-20	-	Current	\$191,000	
Lot 336 Lismore Road	363	12.5	29	Aug-20		Current	\$168,000	
Lot 338 Lismore Road	363	12.5	29	Aug-20		Current	\$168,000	
Lot 578 Bathurst Street	450	15	30	Aug-20	-	Current	\$194,000	
Lot 581 Bathurst Street	450	15	30	Aug-20		Current	\$194,000	
Lot 637 Doley Road	313	12.5	25	Aug-20		Current	\$148,000	
Lot 638 Doley Road	312	12.5	25	Aug-20		Current	\$148,000	

\*Terms and conditions apply - Whilst every care has been taken with the preparation of these particulars, which are believed to be correct, they are in no way warranted by the selling agent or its clients in whole or in part and should not be construed as forming part of any contract. Any intending purchasers are advised to make necessary enquiries to satisfy themselves on all matters in this respect. All areas and dimensions are subject to survey. \*Full retail prices are as advertised. The promotional advertised price excludes an incentive as noted as either a land rebate or builder incentive or other. Any rebate is only applicable on selected lots and is paid at settlement. Sales Agent: Parcel Realty PTY LTD (ABN 66 153 825 542). Licence number: 64283

